

**RoHS**  
COMPLIANT

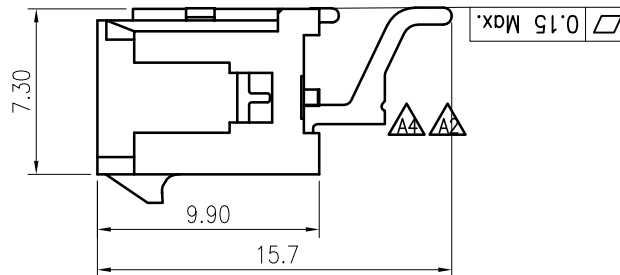
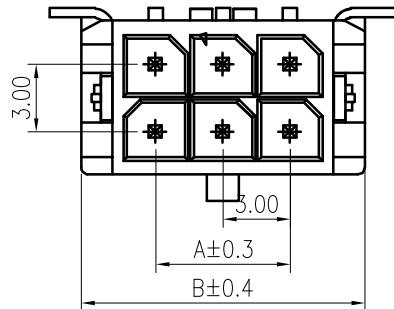

**SPECIFICATIONS**

1. Current rating: 5A AC, DC
2. Voltage rating: 250V AC,DC
3. Temperature range: -40°C ~ +105°C
4. Insulation resistance: 1000MΩ Min.
5. Withstanding voltage: 1500V AC/ minute.
6. Contact resistance: 10mΩ Max.

**Material:**

Insulator: LCP UL 94V-0  
 Contact: Brass/Matte-tin plated over nickel  
 Solder tab: Brass/Matte-tin plated over nickel  
 Circuits: 2\*1~2\*12  
 Mate with KR3000 series dual row housing

**Ordering Code:**

**A4** C3000RS \*\*\* 14 M0101 R A

No. of Circuits ———— Packing  
 201:2x1P, R: Reel Tape  
 2x2:2x2P..... P: Bag  
 Insulator Material  
 14:LCP Black

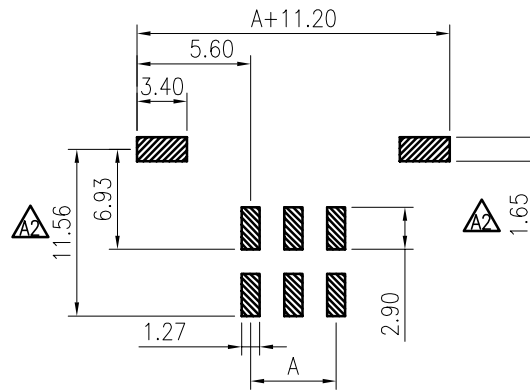
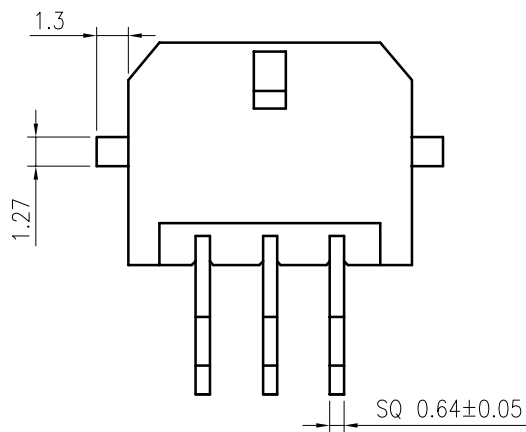

**Recommended P.C.B. Layout**  
 Total tolerance:±0.05mm

PIN NO.	DIMENSIONS		PIN NO.	DIMENSIONS	
	A	B		A	B
2*1P	--	6.65	2*7P	18.00	24.65
2*2P	3.00	9.65	2*8P	21.00	27.65
2*3P	6.00	12.65	2*9P	24.00	30.65
2*4P	9.00	15.65	2*10P	27.00	33.65
2*5P	12.00	18.65	2*11P	30.00	36.65
2*6P	15.00	21.65	2*12P	33.00	39.65

F	<b>A6</b>				TOLERANCE	TITLE:	DRAWN: ru yi 2020.03.10	KONNRA 东莞市康瑞电子有限公司 DongGuan Konnra Electronics Co., Ltd.			
	<b>A5</b>	Uniformly arrange the drawings	Arvin	2021.09.22	X. X ± 0.30	MK3.0 SMF 90° Wafer	CHECKED:				
	<b>A4</b>	Correct view	Arvin	2020.12.26	X. XX ± 0.20	With Solder Tab	APPROVED:	PART NO. : C3000RS2**14M0101RA			
MARK	REVISION DESCRIPTION	SIGNATURE	DATE	X. XXX ± 0.10	Angle ± 2°	UNIT: mm	SCALE: N/A	SHEET: 1/1	PROJECTION	REV. : A5	DRAWING NO. : 3000WRS201-A-S