

RoHS
COMPLIANT

SPECIFICATIONS

1. Current rating: 3A AC, DC
2. Voltage rating: 250V AC,DC
3. Temperature range: -40°C ~ +105°C
4. Insulation resistance: 1000MΩ Min.
5. Withstanding voltage: 800V AC/ minute.
6. Contact resistance: 20mΩ Max.

Material:

Insulator: PA66 UL 94V-0

Contact: Brass

Plating: Tin plated over Nickel

Mate with KR2005 series housing

Ordering Code:

C2005VD *** 22 T01 01PC

No. of Circuits
202:2x2,220:2x20

Plating:
T01: Tin plated

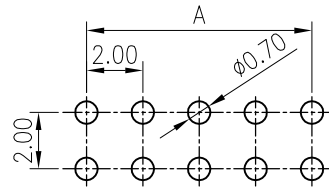
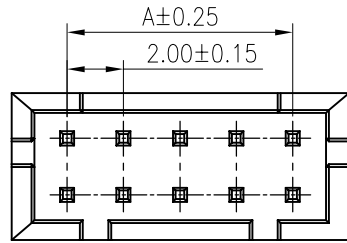

Recommended P.C.B. Layout
Total tolerance:±0.05mm

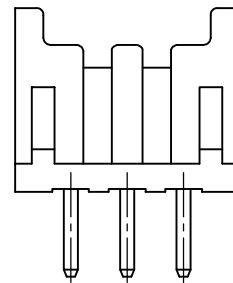
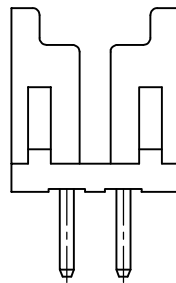
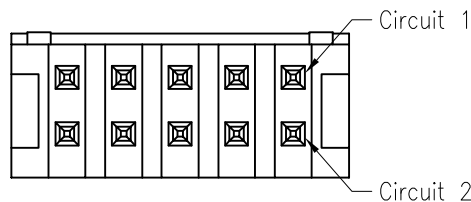
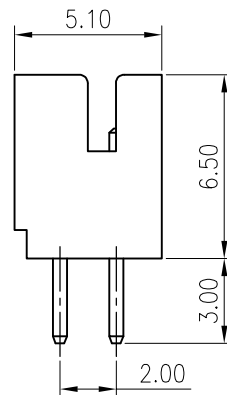
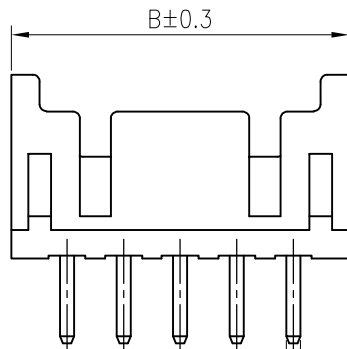

Circuits	Dimensions		Circuits	Dimensions	
	A	B		A	B
2x2	2.00	6.00	2x12	22.00	26.00
2x3	4.00	8.00	2x13	24.00	28.00
2x4	6.00	10.00	2x14	26.00	30.00
2x5	8.00	12.00	2x15	28.00	32.00
2x6	10.00	14.00	2x16	30.00	34.00
2x7	12.00	16.00	2x17	32.00	36.00
2x8	14.00	18.00	2x18	34.00	38.00
2x9	16.00	20.00	2x19	36.00	40.00
2x10	18.00	22.00	2x20	38.00	42.00
2x11	20.00	24.00			



MARK

1

2

3

4

5

6

7

8

9

TOLERANCE

X. X ±0.30

X. XX ±0.20

X. XXX ±0.10

Angle ±2°

TITLE:
PHD2.0 DIP 180°
Wafer

UNIT: mm SCALE: N/A

DRAWN: Arvin 2021.08.13

CHECKED:

APPROVED:

SHEET: 1/1

PROJECTION

KONNRA 东莞市康瑞电子有限公司
DongGuan Konnra Electronics Co., Ltd.

PART NO.: C2005VD*** 22T0101PC

VER.: A1 DRAWING NO.: 2005WDD201-C-S