

RoHS
COMPLIANT

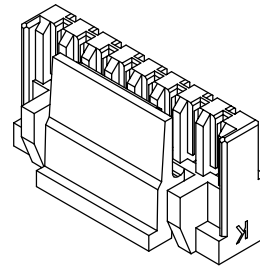
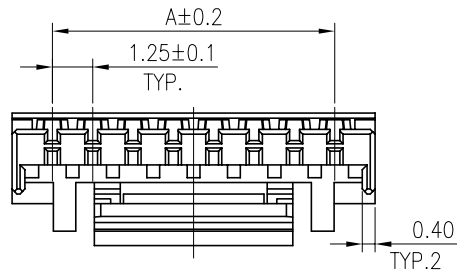
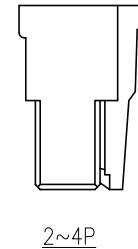
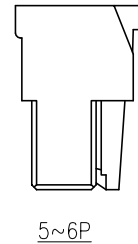
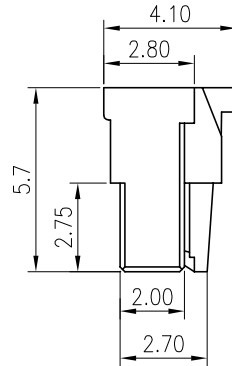
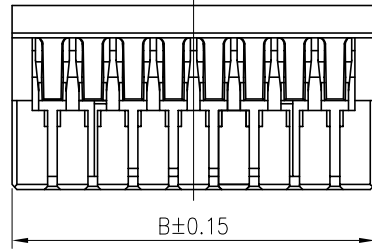
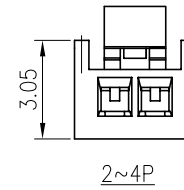
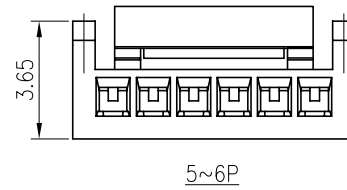
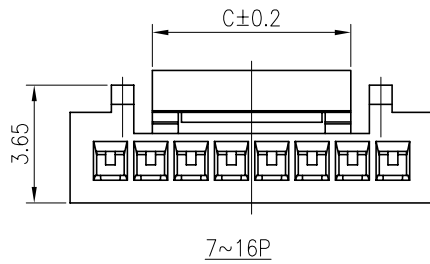

SPECIFICATIONS

1. Current rating: 1A AC, DC
2. Voltage rating: 50V AC, DC
3. Temperature range: -40°C ~ +105°C
4. Insulation resistance: 100MΩ/ min.
5. Withstanding voltage: 500V AC/ minute.
6. Contact resistance: 30mΩ/ max.

Material: PA66 or PBT UL94 V-0
Suitable KR1259 Series Terminal
Mates With KR1259 Series Wafer

Ordering Code:

H125901** **01A

- 102=02P 01: PA66 UL94 V-0 White
- 103=03P 02: PA66 UL94 V-0 Black, HF
- 20: PA66 UL94 V-0 Red
- 24: PBT White

Circuits	Dimensions		
	A	B	C
2	1.25	3.85	1.90
3	2.50	5.10	2.90
4	3.75	6.35	4.15
5	5.00	7.50	4.15
6	6.25	8.75	6.15
7	7.50	10.00	6.15
8	8.75	11.25	6.15
9	10.00	12.50	6.15
10	11.25	13.75	8.10
11	12.50	15.00	8.10
12	13.75	16.25	8.10
13	15.00	17.50	8.10
14	16.25	18.75	8.10
15	17.50	20.00	8.10
16	18.75	21.25	8.10

F	A5	Add specification	ZSZ	2022.03.28	TOLERANCE X.X ±0.25 X.XX ±0.15 X.XXX ±0.08 Angle ±2°	TITLE: GH1.25 Housing	DRAWN: Shen 2021.09.06		KONNRA 东莞市康瑞电子有限公司 DongGuan Konnra Electronics Co., Ltd.		
	A4	Uniformly arrange the drawings	Arvin	2021.09.06			CHECKED:				
	A3	Change the part number and frame format	TLX	2020.03.28			APPROVED:		PART NO. : H125901****01A		
	MARK	REVISION DESCRIPTION	SIGNATURE	DATE			UNIT: mm	SCALE: 1/1	SHEET: 1/1	PROJECTION	REV. : A5
	1	2	3	4	5	6	7	8	9		

RoHS
COMPLIANT

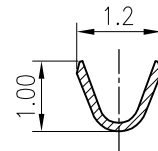
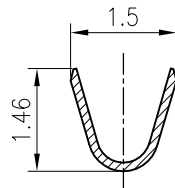
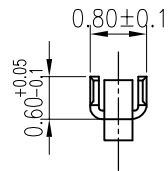
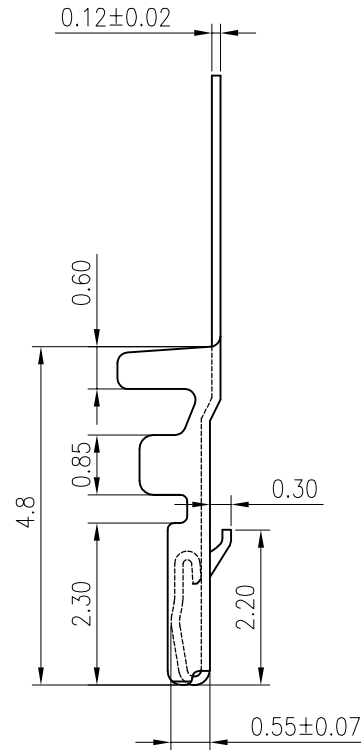
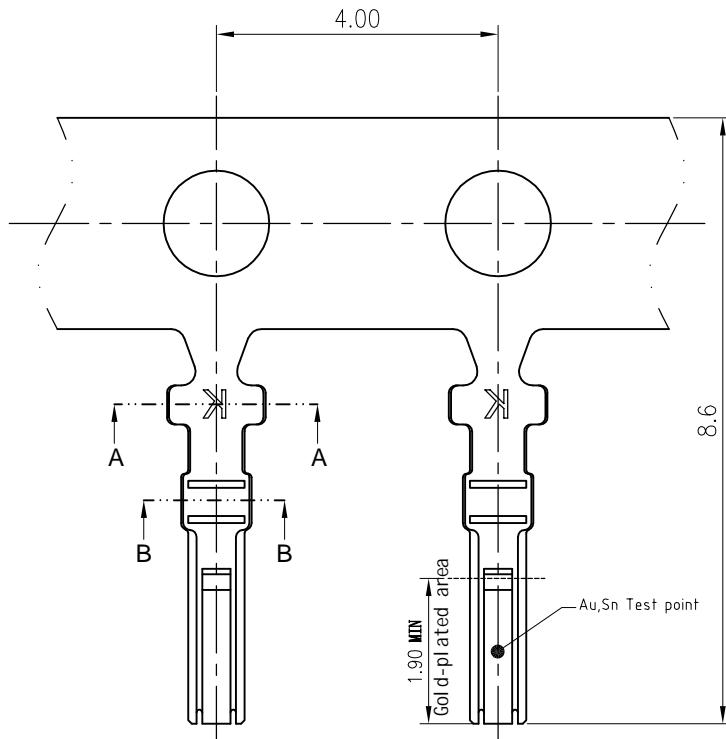

SECTION:A-A

SECTION:B-B

SPECIFICATIONS

1. Current rating: 1A AC, DC
2. Voltage rating: 50V AC, DC
3. Temperature range: -40°C ~ +105°C
4. Insulation resistance: 100MΩ/ min.
5. Withstanding voltage: 500V AC/ minute.
6. Contact resistance: 30mΩ/ max.

Material: Phosphor Bronze

Applicable wires:

Conductor size: AWG#26~#30

Insulation O.D. : 1.0mm Max.

Finish: Tin plated or Gold plated contact area

Suitable KR1259 Series Housing

Mates With KR1259 Series Wafer

Q'TY/Reel: 20,000PCS

Ordering Code:

T12590P *** 01A

S00:Material

T01:Sn

B08:Half Au,Ni

G08:Au40u"

F		Uniformly arrange the drawings	Shen	2021.09.06	TOLERANCE X. X ±0.20 X. XX ±0.15 X. XXX ±0.08 Angle ±2°	TITLE: GH1.25 Terminal		DRAWN: Shen 2021.09.06		KONNRA 东莞市康瑞电子有限公司 DongGuan Konnra Electronics Co., Ltd.			
		Change the part number and frame format	TLX	2020.05.08		CHECKED:		APPROVED:			PART NO. : T12590P***01A		
	MARK	REVISION DESCRIPTION	SIGNATURE	DATE		UNIT: mm	SCALE: 1/1	SHEET: 1/1	PROJECTION	REV. : A4	DRAWING NO. : 1259T01-A-S		
	1	2	3	4		5	6	7	8	9			

RoHS
COMPLIANT

SPECIFICATIONS

1. Current rating: 1A AC, DC
2. Voltage rating: 50V AC, DC
3. Temperature range: -40°C ~ +105°C
4. Insulation resistance: 100MΩ/ min.
5. Withstanding voltage: 500V AC/ minute.
6. Contact resistance: 30mΩ/ max.

Material:

Insulator: PA6T UL94V-0
Contact: Phosphor bronze
Solder tabs: Brass

Finish: Tin plated or selective gold plated over nickel
Mate With KR1259 series housing

Ordering code:

C1259RS *** 09 M01 ** RA $\triangle\triangle$

102: 2P
114: 14P
09: PA6T Natural
11: PA9T Natural

01: Has no card slot
03: Has card slot

M01: Matte TIN
B01: Half Gold & Matte Tin

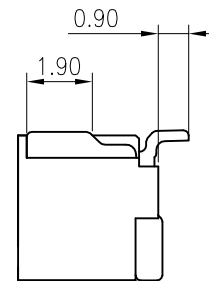
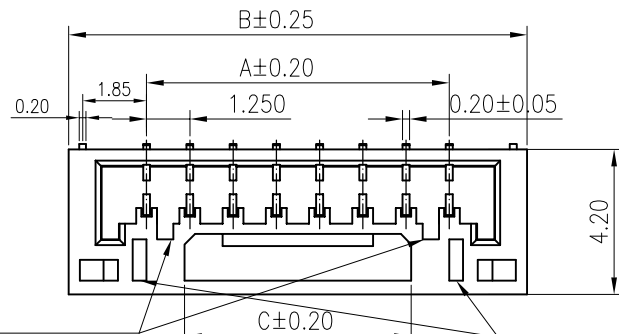

8-16P Has card slot
2-7P Has no card slot

There are two tapping holes above 7P



PIN No.	DIMENSIONS		
	A	B	C
2P	1.25	5.75	2.20
3P	2.50	7.00	3.30
4P	3.75	8.25	4.55
5P	5.00	9.50	4.55
6P	6.25	10.75	6.55
7P	7.50	12.00	6.55
8P	8.75	13.25	6.55
9P	10.00	14.50	6.55
10P	11.25	15.75	8.55
11P	12.50	17.00	8.55
12P	13.75	18.25	8.55
13P	15.00	19.50	8.55
14P	16.25	20.75	8.55
15P	17.50	22.00	8.55
16P	18.75	23.25	8.55

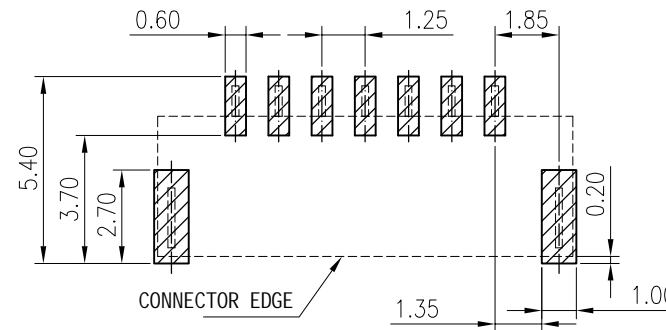
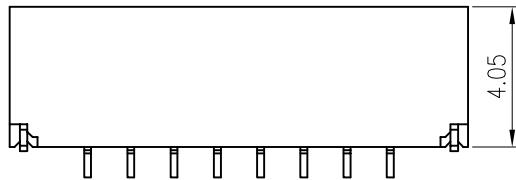

Recommended P.C.Board Layout



F	$\triangle\triangle$	Add specification	ZSZ	2022.8.9	TOLERANCE X.X ±0.30 X.XX ±0.20 X.XXX ±0.10 Angle ±2°	TITLE: GH 1.25 SMT 90° Wafer	DRAWN: Shen 2021.09.03		KONNRA 东莞市康瑞电子有限公司 DongGuan Konnra Electronics Co., Ltd.
	$\triangle\triangle$	Uniformly arrange the drawings	Shen	2021.9.3			CHECKED:		
	$\triangle\triangle$	ADD 14P Specification	Arvin	2021.2.2			APPROVED:		
	MARK	REVISION DESCRIPTION	SIGNATURE	DATE			UNIT: mm	SCALE: 1/1	

RoHS
COMPLIANT

SPECIFICATIONS

1. Current rating: 1A AC, DC
2. Voltage rating: 50V AC, DC
3. Temperature range: -40°C ~ +105°C
4. Insulation resistance: 100MΩ/ min.
5. Withstanding voltage: 500V AC/ minute.
6. Contact resistance: 30mΩ/ max.

Material:

Insulator: PA6T UL94V-0
 Contact: Phosphor bronze
 Solder tabs: Brass
 Finish: Tin plated or selective gold plated over nickel
 Mate With KR1259 series housing

Ordering code:

C1259VS ***09 M01 ** RA

102: 2P 01: Has no card slot
 114: 14P 03: Has card slot

09: PA6T Natural
 11: PA9T Natural

M01: Matte TIN
 B01: Half Gold & Matte Tin

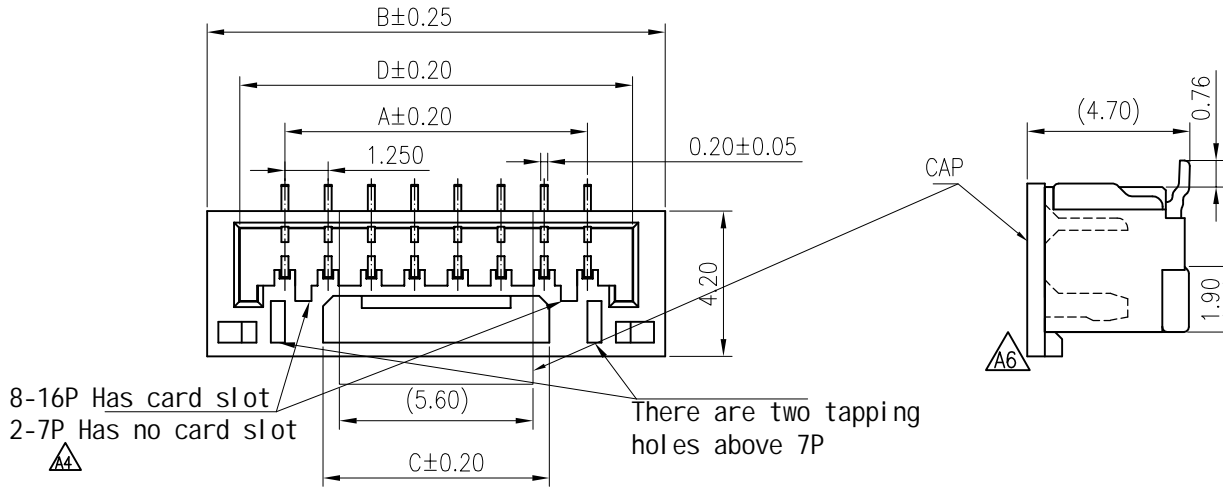

8-16P Has card slot
 2-7P Has no card slot

There are two tapping holes above 7P

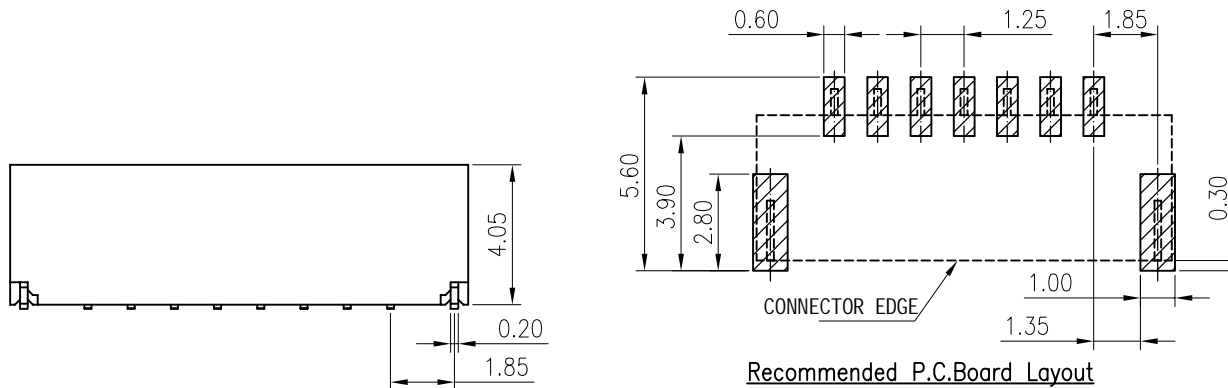

PIN No	DIMENSIONS			
	A	B	C	D
2P	1.25	5.75	2.20	3.75
3P	2.50	7.00	3.30	5.00
4P	3.75	8.25	4.55	6.25
5P	5.00	9.50	4.55	7.50
6P	6.25	10.75	6.55	8.75
7P	7.50	12.00	6.55	10.00
8P	8.75	13.25	6.55	11.25
9P	10.00	14.50	6.55	12.50
10P	11.25	15.75	8.55	13.75
11P	12.50	17.00	8.55	15.00
12P	13.75	18.25	8.55	16.25
13P	15.00	19.50	8.55	17.50
14P	16.25	20.75	8.55	18.75
15P	17.50	22.00	8.55	20.00
16P	18.75	23.25	8.55	21.25

	Add specification	ZSZ	2022.8.9	TOLERANCE X. X ±0.30 X. XX ±0.20 X. XXX ±0.10 Angle ±2°	TITLE: GH 1.25 SMT 180° Wafer	DRAWN: Shen 2021.09.03		KONNRA 东莞市康瑞电子有限公司 DongGuan Konnra Electronics Co., Ltd.	
	Change Cap	Arvin	2022.3.18			CHECKED:		PART NO.: C1259VS***09****RA	
	Uniformly arrange the drawings	Shen	2021.9.3			APPROVED:		REV.: A7 DRAWING NO.: 1259WS01-A-S	
MARK	REVISION DESCRIPTION	SIGNATURE	DATE			UNIT: mm	SCALE: 1/1	SHEET: 1/1	PROJECTION